

1x1, 1x2 Optical Switch

Features

Compact Size
Fast Response Time
Low Insertion Loss

Applications

Protection Switching
Reconfiguration
Optical Subsystems
Array Integration

Specifications

Parameters	Unit	1x1, 1x2		
Operation Wavelength	nm	1310, 1550	850, 1310	980, 1064
Insertion Loss	dB	≤0.5 (Typ. 0.4)	≤0.8 (Typ. 0.6)	≤0.7 (Typ. 0.5)
Return Loss	dB	≥50	≥30	≥50
Cross Talk	dB	≥55	≥30	≥55
Fiber Type		SMF-28	MMF50/125,MMF62.5/125	HI1060
Repeatability	dB	≤±0.05		
Switch Time	ms	10		
Lifetime	Cycle	>10 ⁹		
Switch Mode		Latching or Non-Latching		
Operating Temperature	°C	-15 ~ +70		
Storage Temperature	°C	-40 ~ +85		
Drive Voltage	V	5±0.5 DC or 5V Pulse		
Work Current	mA	<50		
Dimension (L x W x H)	mm	27x12x8.2		

Pins

Switch Type	Optical Path	Electrical Drive		Status Sensor					
		Pin1	Pin10	Pin5	Pin6	Pin2-3	Pin3-4	Pin7-8	Pin8-9
Latching	P1-P2	+V Pulse	GND	N/A	N/A	Open	Close	Close	Open
	P1-P3	GND	+V Pulse	N/A	N/A	Close	Open	Open	Close
Non-Latching	P1-P2	+V	GND	N/A	N/A	Open	Close	Close	Open
	P1-P3	N/A	N/A	N/A	N/A	Close	Open	Open	Close

Package Dimension

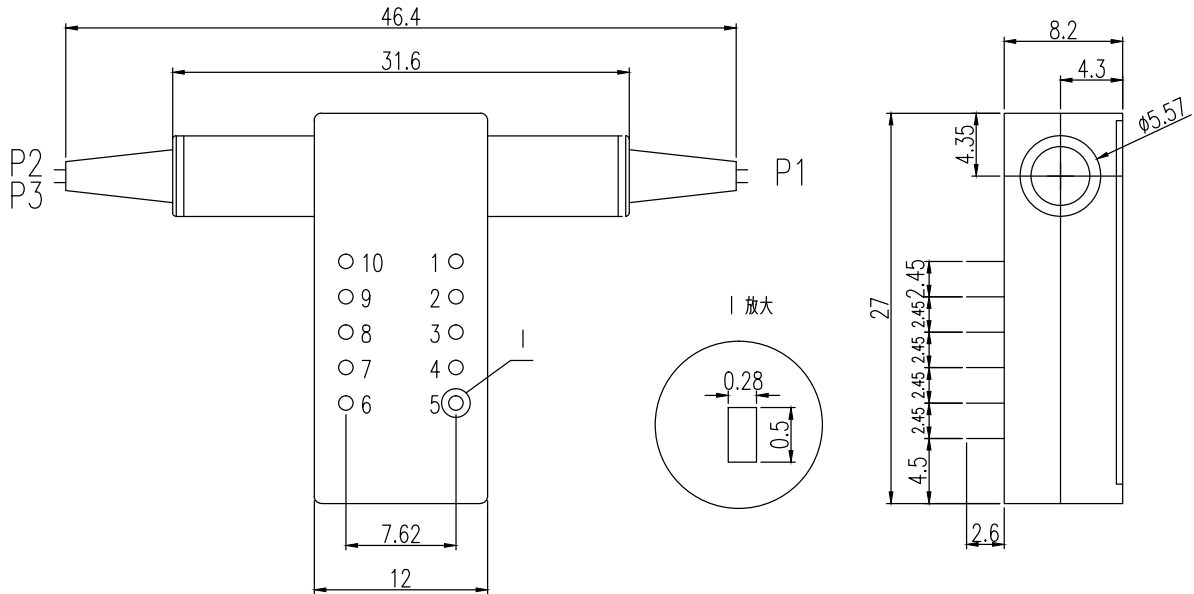

Ordering Information

OSW- ①①①-②②②②-③-④④④-⑤-⑥-⑦⑦

①	Port Type	1x1; 1x2;
②	Wavelength	1310=1310nm; 1550=1550nm; 850=850nm; 980=980nm; 1064=1064nm;
③	Mode	L=Latching; N=Non-Latching;
④	Pigtail Type	250=250μm Fiber; 900=900μm Loose Tube;
⑤	Fiber Type	1=SMF-28; 2=MMF50/125; 3=MMF62.5/125; 4=HI1060;
⑥	Fiber Length	1= 1m;
⑦	Connector	NE=None; FA=FC/APC; FC=FC/UPC; SA=SC/APC; SC=SC/UPC; XX=Others;